

Project Ref : 40B BR SG5 1UE

Project Type : Upper level Rear garden for first owner of new self build

Distance from office : 25 miles : 50 mile round trip

Client initial wish list : prioritised

A decent quality composite material "lounging deck" top left
Bespoke made to measure "chunky" softwood gazebo over deck to suit client's existing upholstered outdoor furniture.

Flat/level lawn in natural turf.

Geometric block built and silicone rendered raised beds - tops levelled all across site. To be hand painted using Little Greene mixed masonry paint
Define vegetable/salad/fruit beds and retain soil using treated softwood sleepers

Venetian style fence down left side - treat with Osmocote

Remainder of original fence to be sprayed grey (Cuprinol)

Supply and lay high quality London Stone Porcelain for dining patio

Matching replacement top step tread and path porcelain

Add "stone sett or clay paver" mowing edge at later date when cash flow available.

Put in conduit and pull through cables to facilitate mains power to top deck and lighting take off points in each planter.

DPM Line/"Black Jack" all raised planters and fill with drainage material and new top soil and fertiliser

Client to supply and plant own planting scheme over time

Challenges

Sloping bottom to top

Sloping across - right to left

No access for a micro digger

Turf and soil to be dug off by hand and carted out down steps and via side path to skip/grabs on front drive - limited space

Distance from materials delivery point to top of garden - all "hand ball and barrow"

Timing :

Design : Feb/Mar 2023 : By ACL with client

Supply and installation by : Verdant and Bright Garden and Home

Timing : August 2023

Size : c 64 sq m

Budget : £22,000

Cost - including client's changes, additions and planting : c£24,680

Current status : returning asap to install a feature plant for central planter e.g. a palm, lights, RF remote control switching and mowing edge and maintain fencing.



2. Client agreed block layout design to be implemented.

1. Site photos : "current reality" As left by developer of the new home :

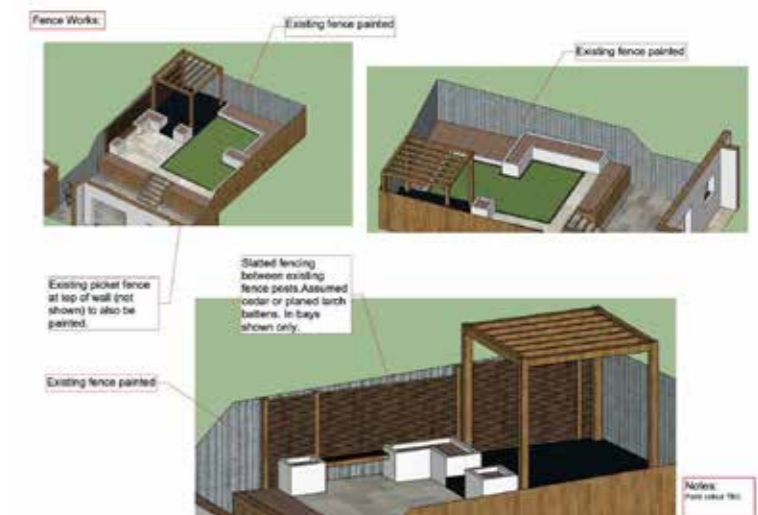

Project Ref : 40B BR SG5 1UE

Project Type : Upper level Rear garden for first owner of new self build



Challenges

Sloping bottom to top

Sloping across - right to left

No access for a micro digger

Turf and soil to be dug off by hand and carted out down steps and via side path to skip/grabs on front drive - limited space

Distance from materials delivery point to top of garden - all "hand ball and barrow"

Size : Transformed top garden c.64 sq m

Budget : £22,000 exc planting

Actual Cost :£24,680 following upgrade to Millboard Decking and including plants and a pc sum for lights (for later installation)

3. Site photos : during construction



4. Site photos : End Result



5. Site photos : End Result : First summer after client initial planting

